

COMPACTORS INC.

Container Packer Series

MODEL
520



520ESII

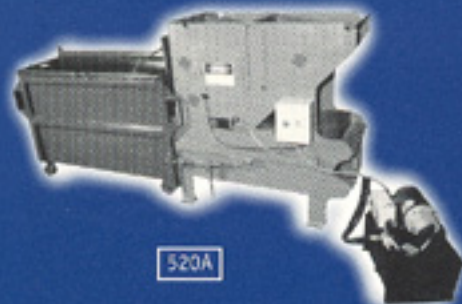

520A



520SS

Overview

Application: A series of industrial stationary container packers typically installed in multi-story buildings. The machines compact trash received from a trash chute and compact into two cubic yard front or rear load compaction containers. The machines operate automatically by an electric eye, providing unattended operation until the container is full at which time it is removed from the machine and wheeled outside for pickup. This system reduces handling of waste and requires less custodial attention, translating into cost savings for owners and property managers. Also, because the volume of trash is significantly reduced during compaction, fewer pickups by the hauler are required, cutting disposal costs.

3 Models to Choose From: The series consists of the Model 520A, Model 520ESII and the Model 520SS. The Model 520A comes equipped with a 5 horsepower power unit for high volume applications. For smaller buildings, the Model 520ESII provides an economical solution with a 1 horsepower power unit. The Model 520SS is specially designed to fit into very small trash rooms where a standard machine won't fit.

Specifications

General Description: A fully automatic, hydraulically operated packer capable of displacing up to 54 cubic yards of trash per hour, packing into a front or rear load compaction container. The machine body, sides and top are 3/16" steel plate reinforced with 3" structural channels for rigidity. Ram is constructed of 3/16" steel for the sides, top and bottom. The ram face is 1/2" steel plate, reinforced. Header bar is 4" X 4" X 3/8" steel angle. The hopper is constructed of 3/16" steel plate with a 1/4" back plate to take the impact of falling refuse. The floor is 1/2" thick steel comprised of two 1/4" plates. One floor plate is part of the frame and the other is replaceable.

Features: A photoelectric sensor starts the compaction cycle when refuse enters the hopper and turns the machine off when hopper is empty. Compactor automatically shuts off if an uncrushable object is encountered. An unload light is provided to signal a full container. A service access door is provided in the hopper, equipped with an electrically interlocked safety switch which prevents the machine from operating if the access door is open. An emergency stop button is provided for safety.

Hydraulic: A prepackaged and assembled power pack is provided. Industry standard components are used in order to make service fast and easy. The compaction cylinder for the 520A and 520ESII has a 3" bore, 1-1/2" rod. The 520SS has a 4" bore, 2" rod.

Electrical: 520A: 208 volts, 60Hz, 3 phase, 4 wire, 5 HP, 15 amps. Other voltages are available upon request. Furnished with a motor starter. Utilizes 115 volt control and logic circuit. Models 520ESII and 520SS: 115 volt, 60Hz, single phase, 1 HP, 15 amps. Power unit mounted on back of machine.

Finish: Painted with a blue industrial grade enamel to provide protection from deterioration.

Containers: Heavy-duty construction to insure long life. Floors are 12 ga. Sides are 10 ga. Provided with heavy duty, phenolic resin casters, 2 fixed and 2 swivel. Available in front load or rear load. One side latching available (optional) for installations where latching can only be accommodated on one side.

520 Container Packer Series

MODEL
520

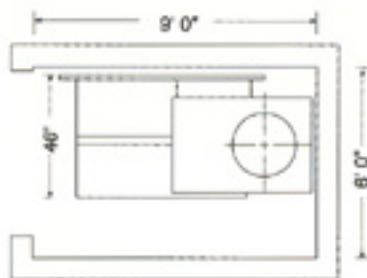

Typical Installation
For 520SS

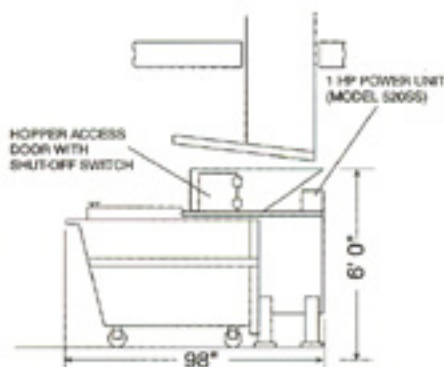

Typical Installation
For 520A / 520ESII

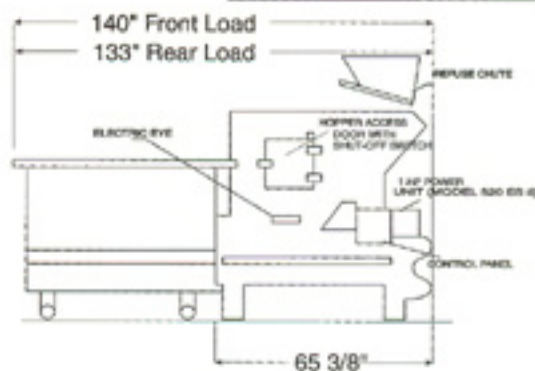
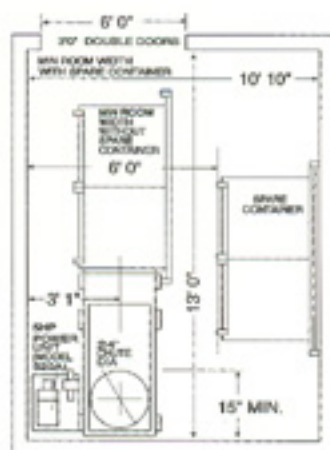

	520A	520ESII	520SS
Chamber Capacity	6.5 cf, .24 cy	6.5 cf, .24 cy	N/A
Compaction Force, Max,	15,075 lbs.	10,360 lbs.	13,815 lbs.
Ram Face Pressure, Max	32.8 psi	22.6 psi	14.5 psi
Volume Displacement	54 cy/hr.	19 cy/hr.	N/A
Cycle Time	16 seconds	44 seconds	60 seconds
Weight, (w/o container)	1,650 lbs.	1,500 lbs.	950 lbs.
Overall Dimensions	65"L x38"W x67"H	65"L x38"W x67"H	51"L x38"W x72"H
Overall Length, w/2 cy front load container	11'8"	11'8"	8'9"
Overall Length, w/2 cy rear load container	11'1"	11'1"	8'2"

Specifications Subject To Change Without Notice

COMPACTORS INC.

Post Office Box 5918 • Hilton Head Island, South Carolina 29938
 Tel: 843-686-5503 or 800-423-4003 • Fax: 843-686-3290 • Email: mjp2150@aol.com
 or visit our Web site at www.compactorsinc.com